



microSI™

MLSI – Vertical (Male)

MLSI vertical board surface mount connectors are used in applications where signal integrity is desired. The connector interface controls the polarization of the connector. Comes with a variety of hardware options.

GENERAL DIMENSIONS

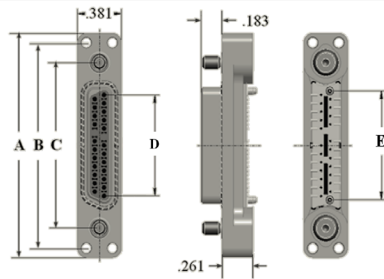

SIZE	A	B	C	D	E
1X	1.863	1.708	1.377	0.840	0.906
4X	2.493	2.338	2.007	1.470	1.536
8X	3.333	3.178	2.847	2.310	2.376

Sample Part Number Format: MLSI-08L-1000-378-2810

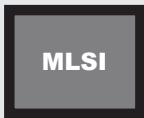

SERIES
 Vertical (Male)
 1.78 mm



SIZE & INTERFACE POLARIZATION*
 01L – 1X Left (23 pins, 4 DP +9SB)
 01R – 1X Right (23 pins, 4 DP +9SB)
 04L – 4X Left (41 pins, 10 DP +9SB)
 04R – 4X Right (41 pins, 10 DP +9SB)
 08L – 8X Left (65 pins, 18 DP +9SB)
 08R – 8X Right (65 pins, 18 DP +9SB)



STYLE
 1000 – Male



PIN TERMINATION (50 μ" Au Contact)
 375 – Sn/Pb alloy
 378 – SAC305



BODY PLATING
 2 – Electroless nickel
 6 – Gold



HARDWARE
 620 – Fixed jacknut
 810 – Turning jackscrews, captivated**
 NXX – Keying jacknuts***
 JXX – Keying jackscrews***

High-Reliability Contact

MIL-DTL-83513

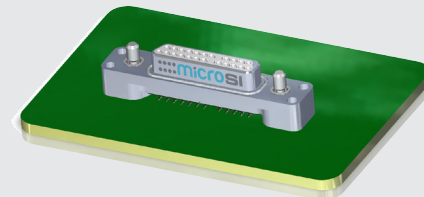
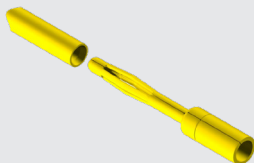

PLEASE CONSULT THE AIRBORN WEBSITE FOR THE LATEST REVISION OF THIS DOCUMENT PRIOR TO BEGINNING ANY DESIGN WORK.

NOTES

- Option not RoHS-compliant.
- * Left or right polarization is determined by looking at the male interface with the LONG SIDE downward. Polarization matches the angled side. Sidebands are on the non-angled side.
- ** Captivated hardware is factory-installed and non-removable.
- *** Factory-installed and non-removable. Refer to "Keying Hardware Options" on page 61.

MATERIALS and FINISHES

- Socket Contact: Brass
- Pin Contacts:BeCu alloy strip
- Contact Finish: Gold plate, 50 μ" minimum
- Shells: Aluminum alloy 6061-T6
- Shell Finishes: Electroless nickel or gold
- Molded Insulators: Glass-filled liquid crystal polymer (LCP)
- Embedment: Frey Eng. Co. compound CF3003-80 & L-II-49
- Hardware: Corrosion-resistant steel
- Interfacial Seal Gaskets: Fluorosilicone
- EMI Gaskets: Corrosion-resistant steel

NOTE: AirBorn can manufacture special configurations to your exact specifications.

SIGNAL INTEGRITY PERFORMANCE (Connectors Only)

1	Diff. Impedance, filtered to 79 ps (20-80%)	100 ohm
2	Diff. Insertion Loss	10 GHz @ -3 dB
3	Diff. Return Loss	7.5 GHz @ -10 dB
4	Intra-Pair	< 2 ps

PERFORMANCE

- Contact Rating: 3 amperes maximum
- Operating Temperature: -55° C to 125° C
- Maximum Working Voltage: 200V, RMS, 60Hz
- Insulation Resistance 5,000 megohms minimum @ 500 VDC
- Durability: 500 connector mating cycles
- Contact Engaging Force: 6.0 ounces maximum/contact
- Contact Separating Force: 0.5 ounces minimum/contact
- Mating and Unmating Force: 10 ounces maximum/contact

NOTE: Performance values are estimates at this time. Actual values will be determined when final product testing is complete.