

Shell Size	Dimensions in mm (inches)																		
	L1		L2		L3		L4		X MAX		D1		D2		D3		W1		M Thread
A	6.5	(0.26)	16.3	(0.64)	3.0	(0.12)	11.5	(0.45)	3.0	(0.12)	15.5	(0.61)	15.0	(0.59)	10.0	(0.39)	10	(0.39)	11 X 0.75
B	8.0	(0.31)	14.9	(0.57)	4.0	(0.16)	10.5	(0.41)	3.5	(0.14)	18.5	(0.73)	17.9	(0.70)	12.0	(0.47)	13	(0.51)	14 X 1
C	7.0	(0.28)	17.7	(0.70)	2.5	(0.10)	12.5	(0.49)	3.0	(0.12)	18.9	(0.74)	17.9	(0.70)	14.0	(0.55)	13	(0.51)	14 X 0.75

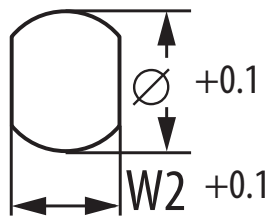

Panel cut out

Size	Dimensions in mm (inches)			
	W2		Ø	
A	10.1	(0.40)	11.1	(0.44)
B	13.1	(0.52)	14.1	(0.56)
C	13.1	(0.52)	14.1	(0.56)

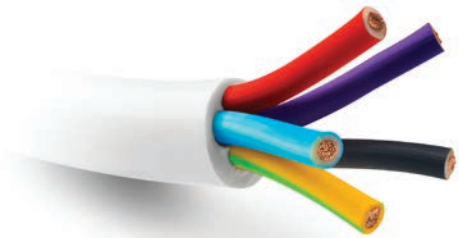

Wire Size Recommendation

Contact Size		Wire Size
mm	Inches	
.6	.02	30-26 AWG

